

OPEN FOR
BOOKING NOW

26 UNITS
双层排屋
**DOUBLE-STOREY
TERRACE HOUSES**

WIDTH: 6.7 M (22FT)
LENGTH: 12.5 M (41 FT)
LAND AREA FROM
4.47 POINTS
**PRICE FROM
RM360,800**

TAMAN LI HUA

— MUKAH —
P H A S E V



19 UNITS
单层排屋
**SINGLE-STOREY
TERRACE HOUSES**

WIDTH: 6.7 M (22FT)
LENGTH: 13 M (42.7 FT)
LAND AREA FROM
4.47 POINTS
**PRICE FROM
RM289,800**



6 UNITS
单层半独立屋
**SINGLE-STOREY
SEMI-DETACHED**

WIDTH: 7.5 M (24.6 FT)
LENGTH: 13 M (42.7 FT)
LAND AREA FROM
9.34 POINTS
**PRICE FROM
RM368,800**

Prime location
In between Mukah Airport
& Mukah Town Centre



Locality Plan



HOCK PENG

For more information, please contact:
Tel : **084-871 376**
H/P : **019-886 2283**
Website : www.hockpeng.org

Site Plan

Legends

- 3 Storey Shophouses (10 units)
- Double Storey Terrace Houses (26 units)
- Single Storey Semi-Detached (6 units)
- Single Storey Terrace Houses (19 units)



DOUBLE-STOREY TERRACE HOUSES

SINGLE-STOREY TERRACE HOUSES

SINGLE-STOREY SEMI-DETACHED

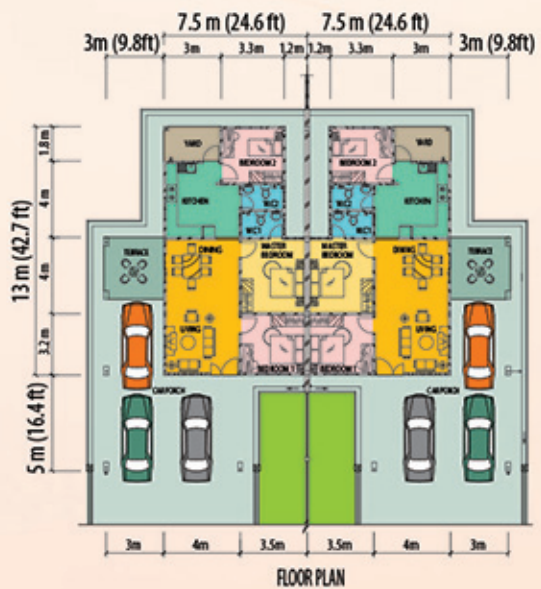
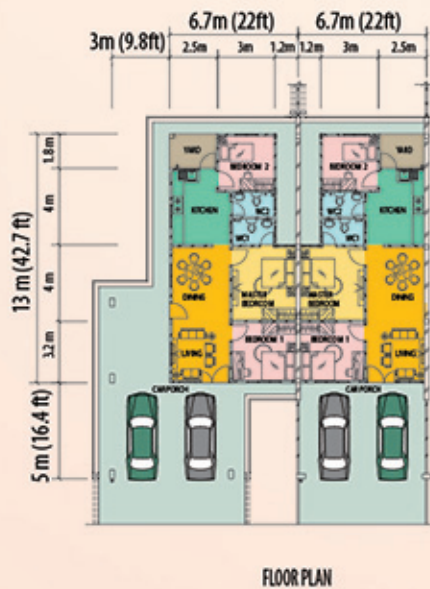
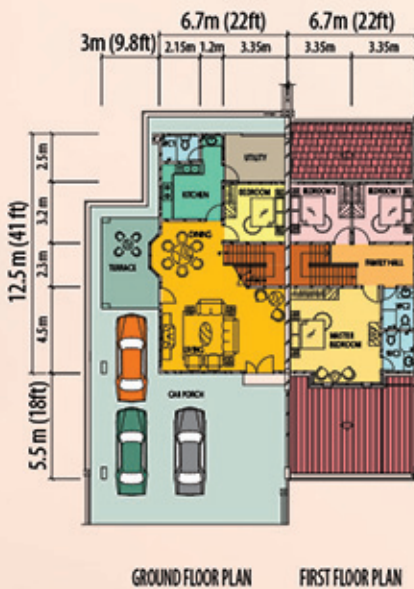

For more information, please contact:



福平實業有限公司

HOCK PENG REALTY SDN BHD (Company No. 20325-D)
(Property Development • CIDB Reg. Grade G7 Contractor) (A member of the Hock Peng Organisation)

Sublot 12, Mukah New Township, 96400 Mukah, Sarawak, Malaysia.

Tel: 084-871 376 H/P: 019-886 2283

All illustrations, scale models, plans, drawings are artist impressions only and shall not form part of any offer or contract. The developer reserves the right to modify a part or parts of the development prior to completion without prior notice. Whilst every care has been taken in providing this information, the developer shall not be held responsible for any inaccuracies.

Housing Developer Licence No. L1453/KP/HD/10/022-R6 valid from 14/07/2016 to 13/07/2017 • Advertisement and Sale Permit No. P2247/KP/HD/10/022-R1 valid from 14/07/2016 to 13/07/2017 • SPA Approval No. SPA/3-08/10D (TP 1/2008) • Building Plan Approved by Majlis Daerah Dalam Dan Mukah Approval No. MDDM/PS/80(1)/232(6) • Expected date of completion: 24 months from the date of Sale & Purchase Agreement • Land Tenure: 60 years



Please scan this QR Code



www.hockpeng.org